

## Introducing Polar Bear

PanelClaw Inc.'s Polar Bear is a revolutionary flat roof photovoltaic mounting system designed by integrators for integrators and available now exclusively through groSolar®, North America's premier provider of solar energy solutions.

Polar Bear's ingenious design offers the lowest component count in the market allowing for easy ordering, simple installation, and hassle free array or roof maintenance.



**Support**



**Claw**



**Deflector**

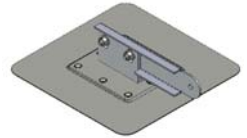

**Roof Connector**

### Why PanelClaw?

#### Speed

- 16 panels in less than 20 minutes with a 3-person crew
- Pre-installed slip sheet and grounding lug

#### Efficiency

- Industry-leading 4-component price list
- Wavy Roof friendly, non-rail-based system
- Tilt up module design for easy maintenance

#### Value

- Industry-best lead times
- Made in the U.S.A. with a 10-year warranty

- Installation angle: Fixed 10 to 15 degrees (depending on module width).
- Max allowable building height: 59 Feet.
- Installed system weight: 3psf to 7psf
- Acceptable Wind Exposure Categories: B and C (D upon request).
- Roof compatibility: EPDM, TPM, PVC, tar and gravel (not compatible with standing metal seam roofs).
- Available mechanical roof attachment option: Eco-Fasten with Polar Bear Roof Connector.

### Order Today



groSolar Sales:  
800.374.4494  
groSolar.com

### More Product Information



info@panelclaw.com  
panelclaw.com

